



# Homed:In

18 Station Road, Southwater, RH13 9HQ



Centenary Road

, Southwater, RH13 9FA

Price Guide £650,000



# Centenary Road



## Description

- VIDEO TOUR of this Stunning 2020 Build in Southwater
- Superior VERY Quiet Position within Development
- Study & WC
- Garage and Driveway
- NO CHAIN
- 4 Bright Double Bedrooms
- Stylish Wide Open Kitchen-Diner
- Utility Room
- Enquire for your Viewing Today





## Floor Plan

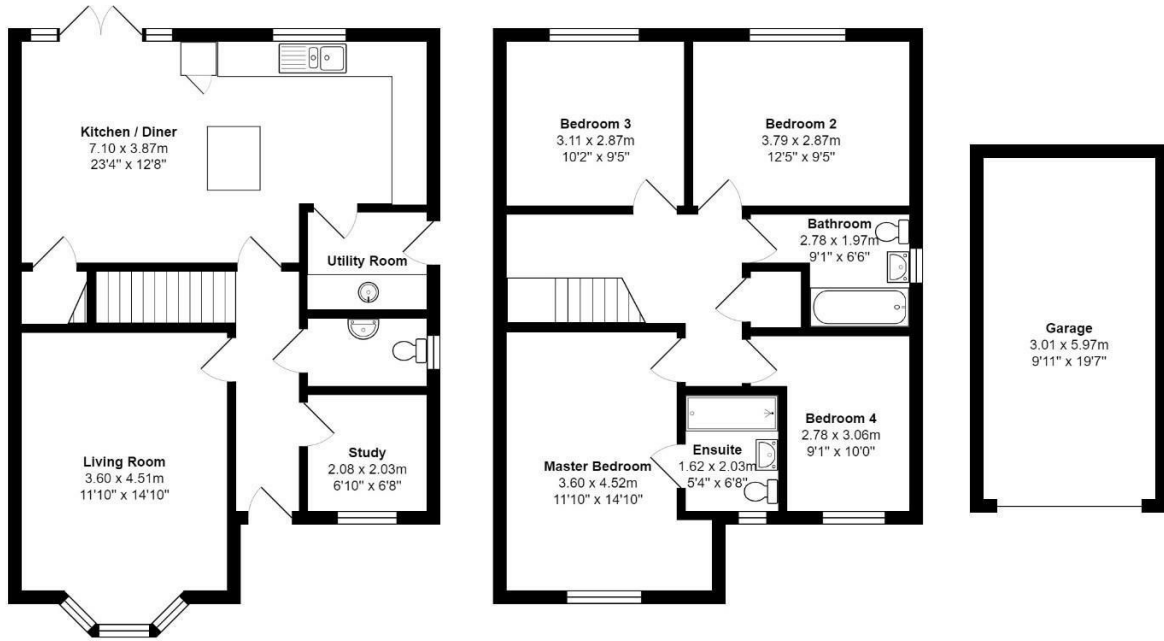

Total Area: 145.2 m<sup>2</sup> ... 1563 ft<sup>2</sup> (Incl Garage)

All measurements are approximate and for display purposes only.  
Copyright 2024. All rights reserved.

## Area Map

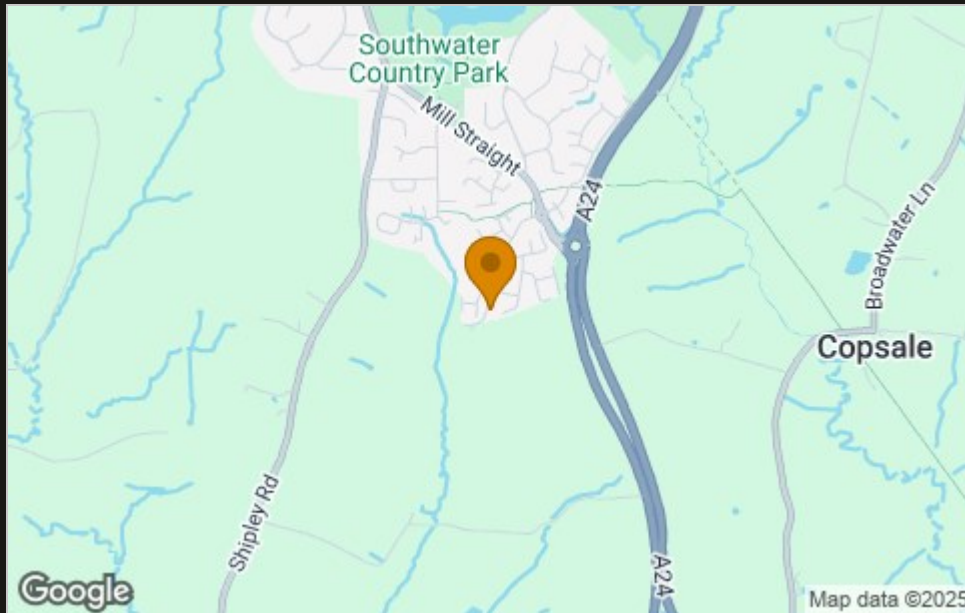

## Energy Efficiency Graph

Energy Efficiency Rating		Current	Potential
Very energy efficient - lower running costs			
(92 plus)	A		
(81-91)	B		
(69-80)	C		
(55-68)	D		
(39-54)	E		
(21-38)	F		
(1-20)	G		
Not energy efficient - higher running costs			
<b>England &amp; Wales</b>		EU Directive 2002/91/EC	
<b>Environmental Impact (CO<sub>2</sub>) Rating</b>		Current	Potential
Very environmentally friendly - lower CO <sub>2</sub> emissions			
(92 plus)	A		
(81-91)	B		
(69-80)	C		
(55-68)	D		
(39-54)	E		
(21-38)	F		
(1-20)	G		
Not environmentally friendly - higher CO <sub>2</sub> emissions			
<b>England &amp; Wales</b>		EU Directive 2002/91/EC	

## Viewing

Please contact our Horsham Office on 01403 597595 if you wish to arrange a viewing appointment for this property or require further information.

These particulars, whilst believed to be accurate are set out as a general outline only for guidance and do not constitute any part of an offer or contract. Intending purchasers should not rely on them as statements of representation of fact, but must satisfy themselves by inspection or otherwise as to their accuracy. No person in this firm's employment has the authority to make or give any representation or warranty in respect of the property.

To **GET A FREE VALUATION** Call us on: **01403 597595**  
or email us at: [info@homedin.co.uk](mailto:info@homedin.co.uk)